



Jan-10

SUSPENSION BLOCK ASSEMBLY.

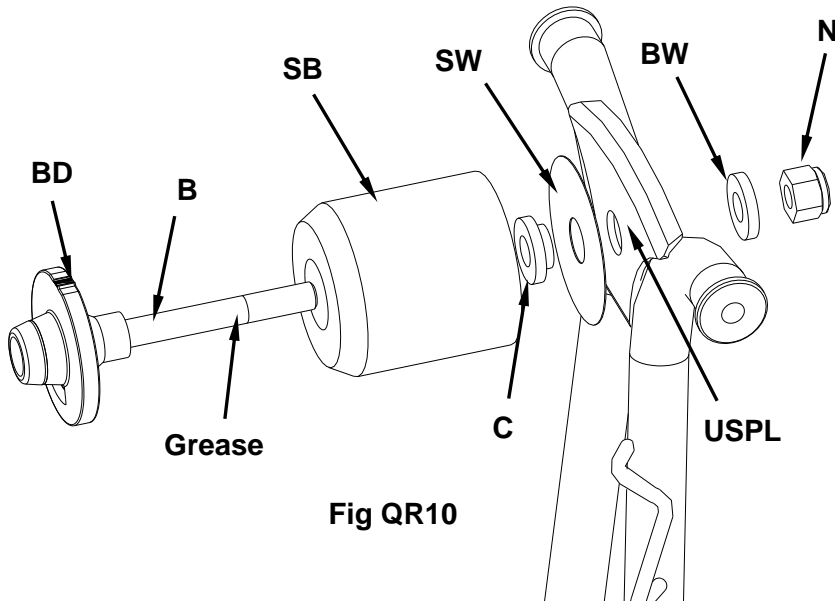

Fig QR10

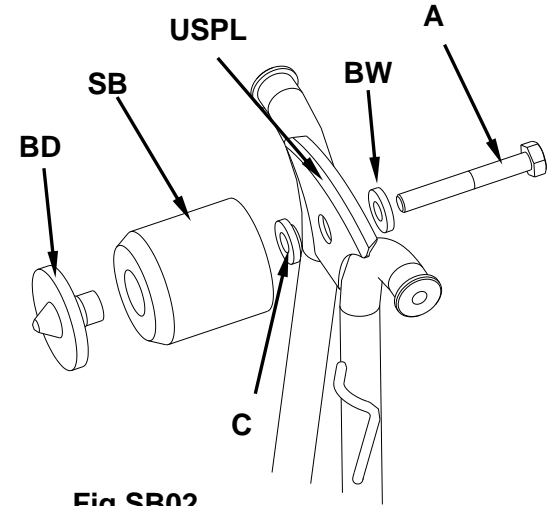

Fig SB02

The two figures show the current assembly (QR10) and the earlier assembly (SB02). In either case you should do up the nut (or bolt) sufficient to compress the suspension block slightly (making the length of the elastomer about 40mm). On reassembly, remember two things, a) apply a little grease to the shank of the bolt (all round it) where it passes through the bush C, and b) make sure that this headed bush, C, projects through the stop plate, USPL, on the rear frame, with its head lying on the **forward** side of the stop plate (while tightening, hold the suspension block steadily against the USPL so that the bush C can't be dislodged)