



BOTTOM BRACKET SPACER

Important information

- In January 2013 a new crankset was introduced with detachable chainrings. This crankset is designed to mount to a JIS taper bottom bracket, it is not compatible with the ISO bottom bracket.
- If you are unsure of the correct fitting process please consult your Brompton dealer. Brompton cannot accept responsibility for any failures due to incorrect fitting or maintenance.
- When using with the 'fixed chainring' crankset (pre 2013) cranks should be tightened to 40Nm.

Fig. 1

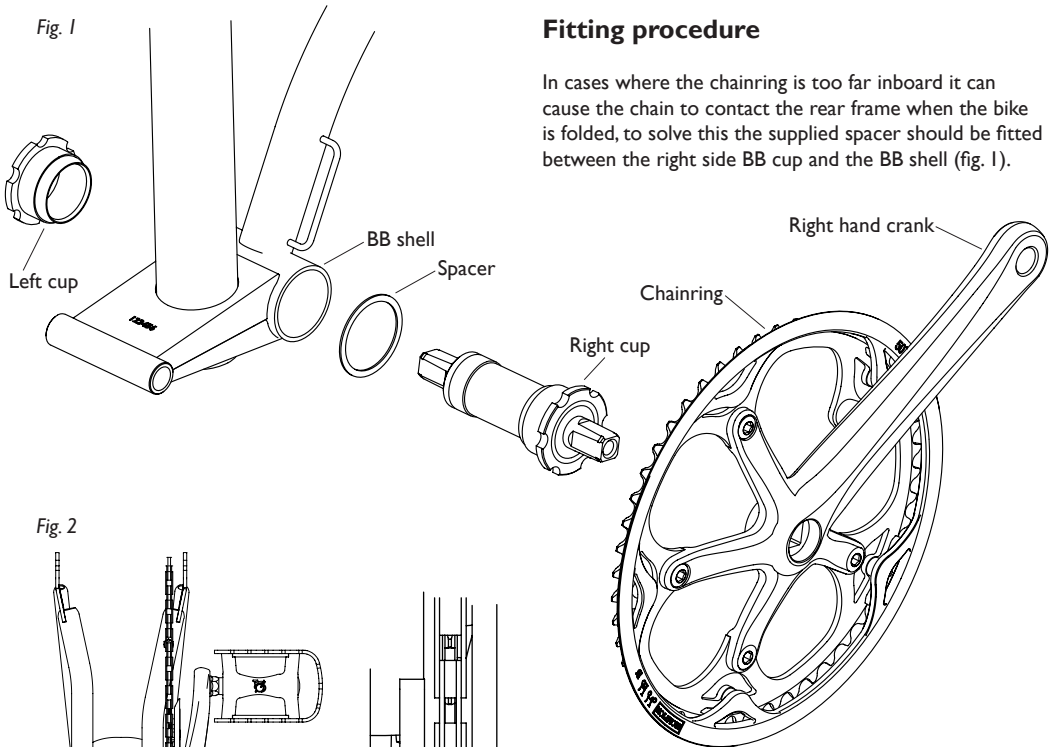

Fitting procedure

In cases where the chainring is too far inboard it can cause the chain to contact the rear frame when the bike is folded, to solve this the supplied spacer should be fitted between the right side BB cup and the BB shell (fig. 1).

Fig. 2

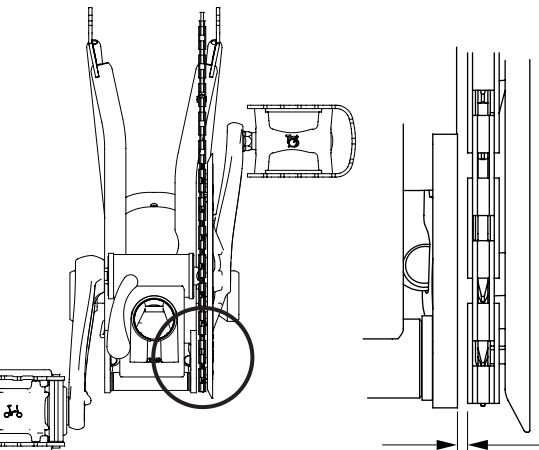

Fitting this spacer offsets the chainring in the outboard direction to create clearance. The gap between the frame and chain when the bike is folded should be at least 1mm (fig. 2).

The bottom bracket cups and crank bolts should be tightened to 30Nm, the bolts checked must be re-checked after approximately 50 miles of riding.